

Zaria VILLAGE

DREAM IT • OWN IT • LIVE IT

1/4 acre fully serviced plots
at the most ideal address

The Zaria Clubhouse



INFRASTRUCTURE AT
80%
COMPLETION

We are creating a gated
community with heart and soul
of like-minded residents.

JOIN OUR COMMUNITY!

ABOUT — ZARIA VILLAGE

Tucked away aptly in the heart of the serene and evergreen Kiambu County is The Zaria Village; a gated family oriented community. The development features 331 quarter (1/4) acre serviced plots available for sale. It is located 25 km from the Central Business District, off the Ruiru-Kiambu bypass.

The Zaria Village offers a quiet and serene environment to pursue quality life for both self and family. The project is in 3 distinct zones: The Zaria Green Gem, The Zaria Grey and the Zaria Golden Rod. The land borders remarkable neighborhoods such as Tatu City, CIC, Fusion Capital, Dew Ridge (Pharmaceutical Society of Kenya) and Amani Ridge (Optiven). It enjoys proximity to top notch schools such as Nova Academy, Wood Creek School and Crawford International School.

The development is centrally located and easily accessible from Nairobi CBD, Westlands,

Kiambu and Thika towns. It has great access to shopping malls and recreational facilities: It is a 10 minute drive from Thika Road Mall and enjoys easy access to Village Market, Two Rivers Mall, Ridgeways Mall, Garden City and the upcoming Tatu City 'Mall of Kenya'.

The Zaria Village is designed to inculcate the concept of a strong and attractive community as well as a pleasant neighborhood to live in while being surrounded by like-minded residents in a modern establishment that maintains a natural and calming ambiance.

Our desire is to ensure that one has pride in ownership and peace of mind in the comfort of your home, all within a zen place that brings joy even just by association. Awaken your desires and bring your dreams to life.

Dream it, Own it and Live it.

SUBDIVISION MAP

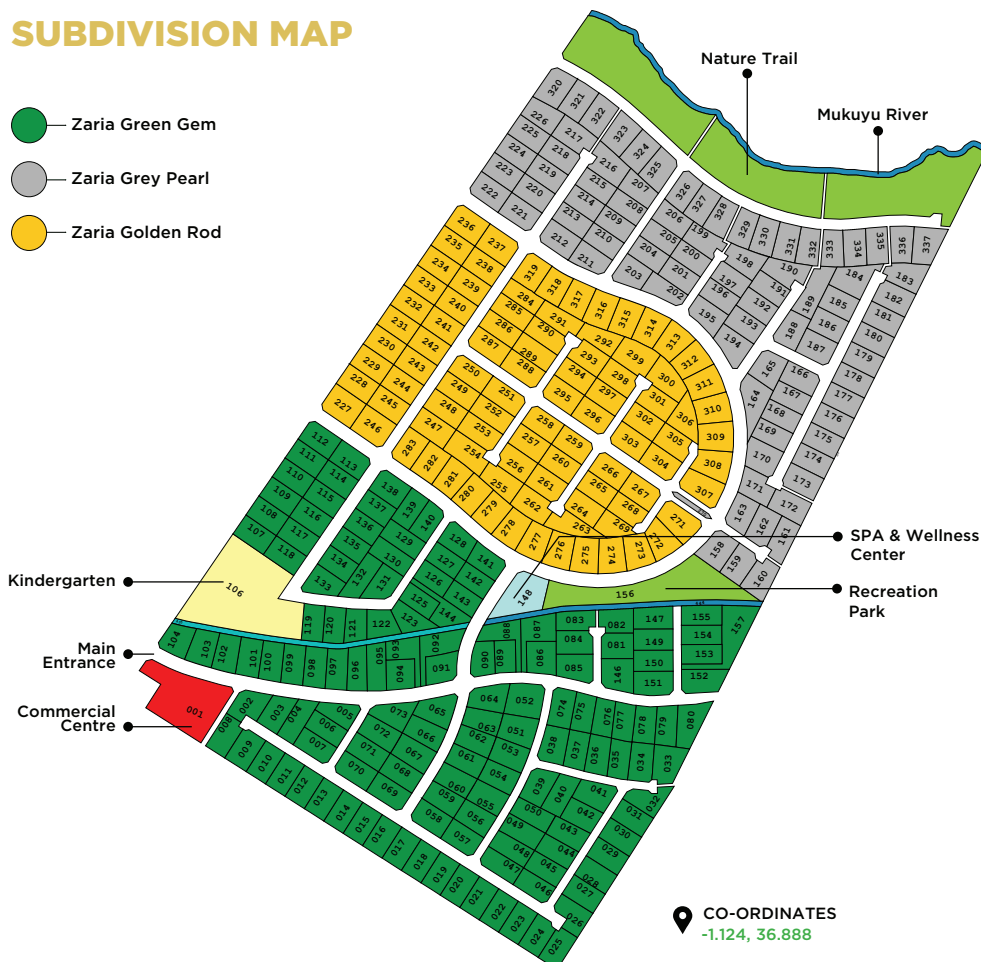

OUR OFFERING

The project subdivision map is in 3 distinct zones.

Prices from **Ksh. 8.4m.**

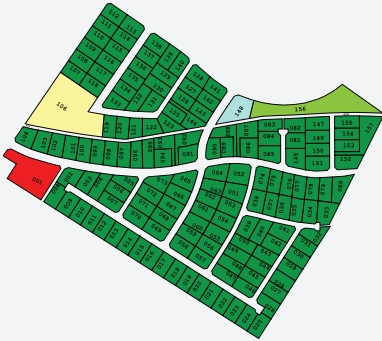

The Zaria Green Gem

Located close to the main entrance, served by 15 meter and 12 meter wide roads. It is the first stop when you get to the project and covers the Kindergarten, and commercial center areas.

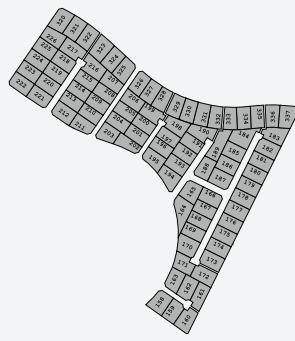

The Zaria Grey Pearl.

Home to Lake Zaad recreational park and the spa, and wellness center. It is also graced by access to a beautifully manicured landscape, natural forest and beautifully clean river.

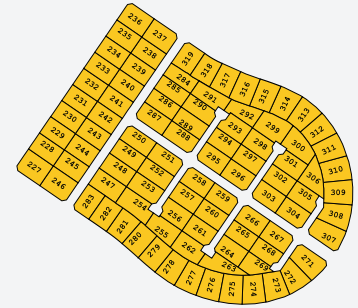

The Zaria Golden Rod.

Home to heights and views. Enclosed in a horseshoe shape at the heart of the project, sits this gem that gives the best views of Nairobi skyline, entire Tatu zone, Kiambu town and environs. Has easy access to all amenities in the village.

A 1/4 acre serviced Plot at The Zaria Village accords you these amenities:



Well-designed stone perimeter wall with an electric fence



2 Recreational Areas, by the river and by the Lake Zaad



Internal Cabro roads



Clubhouse, gym and restaurant



State of the Art main gate with 24/7 caretaker and security.



25m Swimming pool with Kiddy Pool



Power and Water on Site



4 options of scalable house designs



Solar Street Lighting



Provision for an education center



Jogging Track



Provision for a Mini Shopping Complex



**KAMITI CORNER, NEAR
TATU CITY, KIAMBU**
Actual site photos

Zania
VILLAGE
DREAM IT • OWN IT • LIVE IT



FINANCING AVAILABLE WITH

**CIVIL SERVANTS
HOUSING SCHEME
(CSHSF)**

Civil servants to be financed by:
The Civil Servants Housing Scheme
Fund (CSHSF)



Stanbic Bank
A member of Standard Bank Group



NCBA



KCB

BANK

PARTNER

AVG **ADDED
VALUE
GROUP**
Exceeding Expectations



info@addedvaluegroup.co



www.addedvaluegroup.co



0728 313 131